



- KIRK THERMALWALL
- COMMERCIAL PROJECTS
- SUSTAINABILITY
- STONE KIT HOUSES

## The Natural Stone Facade Specialists

Kirk Natural Stone Developments is a family run business with offices in North East Scotland and clients throughout the UK and beyond. We are an ISO14001 accredited company.

We've got extensive expertise in sourcing, specifying and designing practical cost effective natural stone solutions for a wide variety of situations.

We're passionate about natural stone and the invaluable contribution it's made to architecture throughout history. We take a very long standing traditional product and facilitate its use in the modern built environment.

### Kirk ThermalWall

Kirk ThermalWall is a revolutionary insulation backed walling system (UK patent application no:1314022.3), suitable for installation onto a wide variety of building facade types, including both new build and retro-fit applications.

[Read more](#)



Play Video

### Commercial Projects

Our commercial services are used by architects and developers throughout the UK and beyond.

We specialise in providing a tailored service offering expert advice on all aspects of natural stone, its use and supply.

[Read more](#)



### Sustainability

The central principle of sustainability is to create desirable, long lasting places where people will want to live and work.

The design and appearance of the built environment therefore has an important role to play.

[Read more](#)



### News

**Kirk Natural Stone Developments will be attending:**

Nov. 30 - Dec. 2, 2016

Metro Toronto Convention Centre, South Building

North America's Largest Exposition, Networking and Educational Event





## About

> About

Kirk Thermal Wall

Commercial Projects

Sustainability

Request a Quote

Contact us

### Request a Quote

Send

## The Natural Stone Facade Specialists

Kirk Natural Stone Developments is a family run business with offices in North East Scotland and clients throughout the UK and beyond. We are an ISO14001 accredited company.

We've got extensive expertise in sourcing, specifying and designing practical cost effective natural stone solutions for a wide variety of situations.

We're passionate about natural stone and the invaluable contribution it's made to architecture throughout history. We take a very long standing traditional product and facilitate its use in the modern built environment.

### Commercial Stone Specialists

Our products are used in commercial projects such as offices, schools, hotels, healthcare, retail and many large public buildings. We also offer an extensive range of domestic natural stone products.

We work with architects, contractors and developers to source and supply natural stone and provide expert advice and help.

For domestic projects we work directly with home owners to achieve timeless, beautiful and wonderfully practical results every time.

We also sell natural stone products on-line so if you are looking for stone floors we've got the perfect solution.

### Kirk ThermalWall



### Commercial Projects





## Kirk ThermalWall

About

> Kirk Thermal Wall

Commercial Projects

Sustainability

Request a Quote

Contact us

Kirk ThermalWall is a revolutionary insulation backed walling system (UK patent application no:1314022.3), suitable for installation onto a wide variety of building facade types, including both new build and retro-fit applications

Kirk ThermalWall is designed to significantly increase building energy performance and, if used with natural stone facing panels, will also substantially improve building appearance and lifespan.

The Kirk ThermalWall system is lightweight, easy to install and available in a wide range of material types, colours and textures, for residential, office, industrial, education, healthcare, leisure, public sector and tourism building projects.



For more information about the benefits of using Kirk ThermalWall for new build or retrofit projects. [Click here to download our brochure.](#)

### Request a Quote





### Sustainability



### Commercial Projects





## Commercial Projects

About

Kirk Thermal Wall

✓ Commercial Projects

Building Products

Flooring Products

Landscaping

Rainscreen Cladding

Commercial Worktops

The Cost of Building Stone

Property Development

Retro Fitting

Sustainability

Request a Quote

Contact us



Our commercial services are used by architects and developers throughout the UK and beyond.

We specialise in providing a tailored service offering expert advice on all aspects of natural stone, its use and supply.

Feel free to contact us for a no obligation quote or to simply ask a question related to natural stone.

If you are looking for a natural stone specialist we guarantee 100% satisfaction, Please browse through some of our completed projects.

Expert advice on natural stone for architects and developers...

## Request a Quote

Name

Email

Message

Send

## Commercial Projects



## Kirk ThermalWall

Thermal Wall  
Facing System

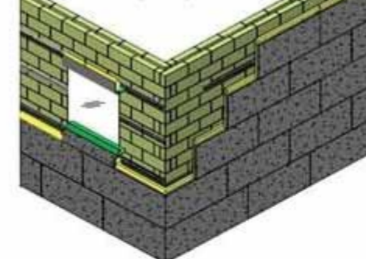

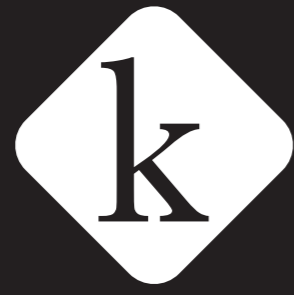

## Building Products

About

Kirk Thermal Wall

Commercial Projects

Building Products

Flooring Products

Landscaping

Rainscreen Cladding

Commercial Worktops

The Cost of Building Stone

Property Development

Retro Fitting

Sustainability

Request a Quote

Contact us

Using a wide range of natural building stone both from within the UK and around the globe Kirk Natural Stone Developments offer building solutions in natural stone or any building project.

The materials we offer include hand selected locally sourced random walling stone, well suited to rural projects, to 20 or 25mm sandstone/granite facing systems for new build or to transform run down drab looking street facades on a wholesale basis.

We are particularly interested to discuss our 20 and 25mm facing systems with housing associations, commercial, retail and healthcare property owners. In most cases the cost of re-facing and upgrading buildings will be less in both financial and environmental terms than the total demolition of tired looking buildings.

Whatever the building project Kirk Natural Stone Developments are always pleased to offer expertise and advice to provide a solution in natural stone.

## Case Studies



**Rough Punched Balmoral Grey Granite Wall Coping**  
Malmaison Hotel, Aberdeen  
Architect: Curious Architecture, Glasgow



**Nero Ardesia Stoneskin Wall Cladding**  
Malmaison Hotel, Aberdeen  
Architect: Curious Architecture, Glasgow



**Rough Punched Balmoral Grey Granite Wall Coping**  
Malmaison Hotel, Aberdeen  
Architect: Curious Architecture, Glasgow



**Nero Ardesia Stoneskin Wall Cladding**  
Malmaison Hotel, Aberdeen  
Architect: Curious Architecture, Glasgow



**Rough Punched Balmoral Grey Granite Wall Coping**  
Malmaison Hotel, Aberdeen  
Architect: Curious Architecture, Glasgow



**Nero Ardesia Stoneskin Wall Cladding**  
Malmaison Hotel, Aberdeen  
Architect: Curious Architecture, Glasgow



**Rough Punched Balmoral Grey Granite Wall Coping**  
Malmaison Hotel, Aberdeen  
Architect: Curious Architecture, Glasgow



**Nero Ardesia Stoneskin Wall Cladding**  
Malmaison Hotel, Aberdeen  
Architect: Curious Architecture, Glasgow



**Rough Punched Balmoral Grey Granite Wall Coping**  
Malmaison Hotel, Aberdeen  
Architect: Curious Architecture, Glasgow



**Nero Ardesia Stoneskin Wall Cladding**  
Malmaison Hotel, Aberdeen  
Architect: Curious Architecture, Glasgow

## Request a Quote

Name

Email

Message

Send

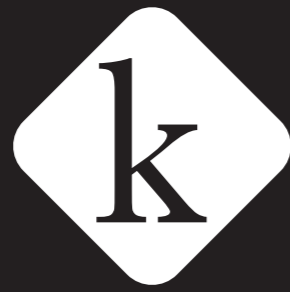

## Flooring Products

About

Kirk Thermal Wall

Commercial Projects

Building Products

Flooring Products

Landscaping

Rainscreen Cladding

Commercial Worktops

The Cost of Building Stone

Property Development

Retro Fitting

Sustainability

Request a Quote

Contact us

The range of flooring available from Kirk Natural Stone Developments includes slate, sandstone, limestone, marble, granite and terracotta.

Whether your project has a need for a chic modern look or traditional style we have a flooring material to suit. The colour choice is vast and several finishes are available including riven, honed, polished, antique and brossato.

Natural stone flooring offers a clean, hard wearing and healthy flooring option, free from dust and dirt which can affect softer floor coverings. When used with underfloor heating, natural stone flooring becomes a beautiful and luxurious option.

## Case Studies



**Balmoral Grey Flame Textured Granite Flooring**

Subsea7 Headquarters, Westhill, Aberdeen

Architect: Michael Gilmour Associates



**Riven Black Slate Flooring**

Malmaison Hotel, Aberdeen

Architect: Curious Architecture, Glasgow



**Rough Punched Balmoral Grey Granite Wall Coping**

Malmaison Hotel, Aberdeen

Architect: Curious Architecture, Glasgow



**Nero Ardesia Stoneskin Wall Cladding**

Malmaison Hotel, Aberdeen

Architect: Curious Architecture, Glasgow



**Rough Punched Balmoral Grey Granite Wall Coping**

Malmaison Hotel, Aberdeen

Architect: Curious Architecture, Glasgow



**Nero Ardesia Stoneskin Wall Cladding**

Malmaison Hotel, Aberdeen

Architect: Curious Architecture, Glasgow



**Rough Punched Balmoral Grey Granite Wall Coping**

Malmaison Hotel, Aberdeen

Architect: Curious Architecture, Glasgow



**Nero Ardesia Stoneskin Wall Cladding**

Malmaison Hotel, Aberdeen

Architect: Curious Architecture, Glasgow



**Rough Punched Balmoral Grey Granite Wall Coping**

Malmaison Hotel, Aberdeen

Architect: Curious Architecture, Glasgow



**Nero Ardesia Stoneskin Wall Cladding**

Malmaison Hotel, Aberdeen

Architect: Curious Architecture, Glasgow

## Request a Quote

Name

Email

Message

Send



**kirk**  
natural stone  
developments

**Contact Us**

Tel: 01888 511399

Mob: 07855 986217

Email: info@kirknaturalstone.com

[HOME](#)

[ABOUT](#)

[SERVICES](#)

[REQUEST A QUOTE](#)

[CONTACT](#)



## Landscaping

About

Kirk Thermal Wall

✓ Commercial Projects

Building Products

Flooring Products

Landscaping

Rainscreen Cladding

Commercial Worktops

The Cost of Building Stone

Property Development

Retro Fitting

Sustainability

Request a Quote

Contact us

Kirk Natural Stone Developments supply a wide range of natural stone hard landscaping products including aggregates, cobbles, feature stones, rockery stones, paving, walling stone, drilled stones and water features.

For commercial projects we are pleased to assist and advise architects, specifiers and developers concerning the use of materials which will enhance the project and take into account budgetary constraints.

### Case Studies



**Modak Riven Sandstone Flagstones**  
Loch Lomond Golf Club Spa  
Architect: The William Cowie Partnership



**Fine Picked Grey Granite Sett Paving**  
Malmaison Hotel, Aberdeen  
Architect: Curious Architecture, Glasgow



**Rough Punched Balmoral Grey Granite Wall Coping**  
Malmaison Hotel, Aberdeen  
Architect: Curious Architecture, Glasgow



**Nero Ardesia Stoneskin Wall Cladding**  
Malmaison Hotel, Aberdeen  
Architect: Curious Architecture, Glasgow

### Request a Quote

Name

Email

Message

Send

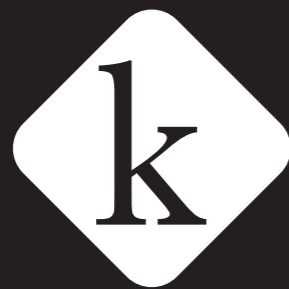

## Rainscreen Cladding

About

Kirk Thermal Wall

Commercial Projects

Building Products

Flooring Products

Landscaping

Rainscreen Cladding

Commercial Worktops

The Cost of Building Stone

Property Development

Retro Fitting

Sustainability

Request a Quote

Contact us

Rainscreen cladding in a variety of natural stone materials including polished, honed or fine picked granite, ashlar sandstone and honed limestone can be applied to a variety of building structure types.

We offer architects a bespoke design surface for any situation and where required can recommend lower cost natural stone facing options, which enable stone elements to be retained along with the prestige aspect of the project.

Design, design and design are the key elements to the successful creation of long lasting building facades in natural stone, and at Kirk Natural Stone Developments the depth of our experience ensures that anything we propose will work.

### Case Studies



**Rosa Porrino Flame Textured Granite Cladding**

Petrofac Headquarters, Aberdeen

Architect: Halliday Fraser Munro



**Luna Pearl Polished Granite Cladding**

Finnies Jewellers, Aberdeen

Architect: Aberdeen Building Design



**Rough Punched Balmoral Grey Granite Wall Coping**

Malmaison Hotel, Aberdeen

Architect: Curious Architecture, Glasgow



**Nero Ardesia Stoneskin Wall Cladding**

Malmaison Hotel, Aberdeen

Architect: Curious Architecture, Glasgow



**Rough Punched Balmoral Grey Granite Wall Coping**

Malmaison Hotel, Aberdeen

Architect: Curious Architecture, Glasgow



**Nero Ardesia Stoneskin Wall Cladding**

Malmaison Hotel, Aberdeen

Architect: Curious Architecture, Glasgow



**Rough Punched Balmoral Grey Granite Wall Coping**

Malmaison Hotel, Aberdeen

Architect: Curious Architecture, Glasgow



**Nero Ardesia Stoneskin Wall Cladding**

Malmaison Hotel, Aberdeen

Architect: Curious Architecture, Glasgow



**Rough Punched Balmoral Grey Granite Wall Coping**

Malmaison Hotel, Aberdeen

Architect: Curious Architecture, Glasgow



**Nero Ardesia Stoneskin Wall Cladding**

Malmaison Hotel, Aberdeen

Architect: Curious Architecture, Glasgow



**Rough Punched Balmoral Grey Granite Wall Coping**

Malmaison Hotel, Aberdeen

Architect: Curious Architecture, Glasgow



**Nero Ardesia Stoneskin Wall Cladding**

Malmaison Hotel, Aberdeen

Architect: Curious Architecture, Glasgow

### Request a Quote

Name

Email

Message

Send





**kirk**  
natural stone  
developments

Contact Us

Tel: 01888 511399

Mob: 07855 986217

Email: info@kirknaturalstone.com

HOME

ABOUT

SERVICES

REQUEST A QUOTE

CONTACT



## Commercial Worktops

About

Kirk Thermal Wall

✓ Commercial Projects

Building Products

Flooring Products

Landscaping

Rainscreen Cladding

Commercial Worktops

The Cost of Building Stone

Property Development

Retro Fitting

Sustainability

Request a Quote

Contact us

Kirk Natural Stone Developments provide a specialist UK wide manufacturing service for Granite, Quartz Composite, Silestone and Slate worktops, and also Limestone and marble vanity tops.

All these materials will enhance any project with an appearance far superior to man made products.

By utilising the latest CNC machine technology Kirk Natural Stone Developments can consistently manufacture worktops to the highest standards.

We have supplied worktops, reception desk tops and vanity units to many prestigious commercial projects, including offices, hotels and leisure complexes, in addition to many thousands of private customers located throughout the UK from Stornaway to Deal.

### Case Studies



Blanco Norte Silestone Bar Top



Azul Enjoy Silestone Food Counter Top Counter



Giallo Veneziano Polished Granite Counter Top

Bon Accord Shopping Centre, Aberdeen  
Client: Willowtree Management Company



Kashmir Gold Polished Granite Bar Top

Dalziel Country Park, Motherwell

### Request a Quote

Name

Email

Message

Send

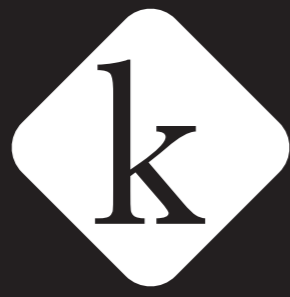

**kirk**  
natural stone  
developments

Contact Us

Tel: 01888 511399

Mob: 07855 986217

Email: info@kirknaturalstone.com

HOME

ABOUT

SERVICES

REQUEST A QUOTE

CONTACT



## The Cost of Building Stone

About

Kirk Thermal Wall

Commercial Projects

Building Products

Flooring Products

Landscaping

Rainscreen Cladding

Commercial Worktops

The Cost of Building Stone

Property Development

Retro Fitting

Sustainability

Request a Quote

Contact us



Natural Stone is often perceived as an expensive façade material, and it's usage therefore restricted to features rather than total façade construction.

Below are some examples of the additional short term cost to typical projects of using natural stone, rather than timber cladding or render.

PROJECT TYPE	PROJECT BUILD COST	ADDITIONAL COST FOR STONE	% PROJECT COST INCREASE FOR STONE
Detached house - 140sq.m walls, 150sq.m floor area 100mm natural stone in place of dry dash rendered block	£180k	+£90/sq.m	+7%
Mid terraced affordable house - 30sq.m walls, 70sq.m floor area 100mm natural stone in place of dry dash rendered block	£84k	+£90/sq.m	+3.21%
Primary school building - 460sq.m walls 40mm stone rainscreen in place of timber cladding	£8m	+£300/sq.m	+1.73%
Health care building - 420sq.m wall area 100mm natural stone in place of dry dash rendered block	£3.5m	+£90/sq.m	+1.08%

In the long term however, natural stone facades become extremely cost effective on account of their requirement for virtually no maintenance, and ability to outlast the typical 30-60 year life of other materials by an order of magnitude.

This extent of lifespan is not merely a claim, because unlike any other material the longevity of natural stone facades is supported by historical evidence from the many centuries old natural stone buildings across the UK.

### Request a Quote

Name

Email

Message

Send

### Commercial Projects



### Kirk ThermalWall





## Property Development

### About

Kirk Thermal Wall

### Commercial Projects

Building Products

Flooring Products

Landscaping

Rainscreen Cladding

Commercial Worktops

The Cost of Building Stone

Property Development

Retro Fitting

Sustainability

Request a Quote

Contact us

Kirk Natural Stone Developments offer a full all-trades, internal & external property developments service

We can carry out works on all types of stone buildings, and by the careful and selective use of natural stone detailing, we are able to improve the appearance and longevity of any structurally sound building.

Well Designed natural stone features can be used to improve appearance, add value and are highly cost effective on a whole life cycle basis, both financially and environmentally.

Refurbishment is a real alternative to demolition of buildings which look past their best!



Download our Property Development Leaflet

## Case Studies

### Project Profile: Castle of Auchry Cottage, Aberdeenshire

Castle of Auchry Cottage was restored by Kirk Natural Stone Developments during March to June 2010.

## Request a Quote

### Before



Exterior



Exterior



Exterior



Exterior

### After



Exterior restored with natural stone detailing



Exterior restored with natural stone detailing



Exterior restored with natural stone detailing



Exterior restored with natural stone detailing

### Project Profile: The Old Bakery, Oldmeldrum, Aberdeenshire

The Old Bakery, Oldmeldrum was converted into modern commercial premises during September 2010 to April 2011.

### Before



Exterior



Exterior

### After



Exterior restored with natural stone detailing



Exterior restored with natural stone detailing

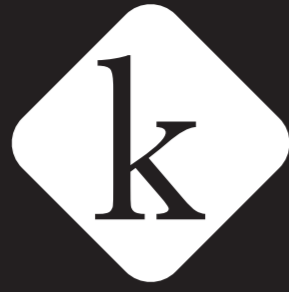

## Retro Fitting

About

Kirk Thermal Wall

✓ Commercial Projects

Building Products

Flooring Products

Landscaping

Rainscreen Cladding

Commercial Worktops

The Cost of Building Stone

Property Development

Retro Fitting

Sustainability

Request a Quote

Contact us

Natural stone facings can be fixed to any structurally sound building to improve appearance and extend building life. Our 20mm granite and sandstone systems, and Tier system, allow a 'seamless' transformation of tired looking buildings, domestic or commercial. Retro-fitting is more sustainable, kinder to the environment and more cost effective than demolition and total re-build. Before committing to the additional expense of total demolition and re-build contact us to discuss the retro-fitting option.

## Case Studies



Retro Fitting 20mm Sandstone



House with Sandstone Walling

## Request a Quote

Name

Email

Message

Send



## Sustainability

About

Kirk Thermal Wall

Commercial Projects

> Sustainability

Request a Quote

Contact us

### Request a Quote

Name

Email

Message

Send

### Creating Desirable Long Lasting Places

The central principle of sustainability is to create desirable, long lasting places where people will want to live and work.

The design and appearance of the built environment therefore has an important role to play.

Sustainability is central to our business. We always consider the environmental, social and economic impacts of using the stone we source and supply.

We always endeavour to lower the carbon footprint of our activities, we work closely with communities in which we operate and we consider natural habitats. We also understand the need for post quarry site restoration.

### The Most Sustainable Building Material Available

Natural stone is the most sustainable building material available, and the only material which history has proved can create attractive long lasting places which in every sense stand the test of time.

Well designed natural stone buildings are timeless, long lasting and highly cost effective on a whole life cycle basis, both financially and environmentally.

Traditional or contemporary, natural stone is the most sustainable choice.



Download Sustainability Information brochure

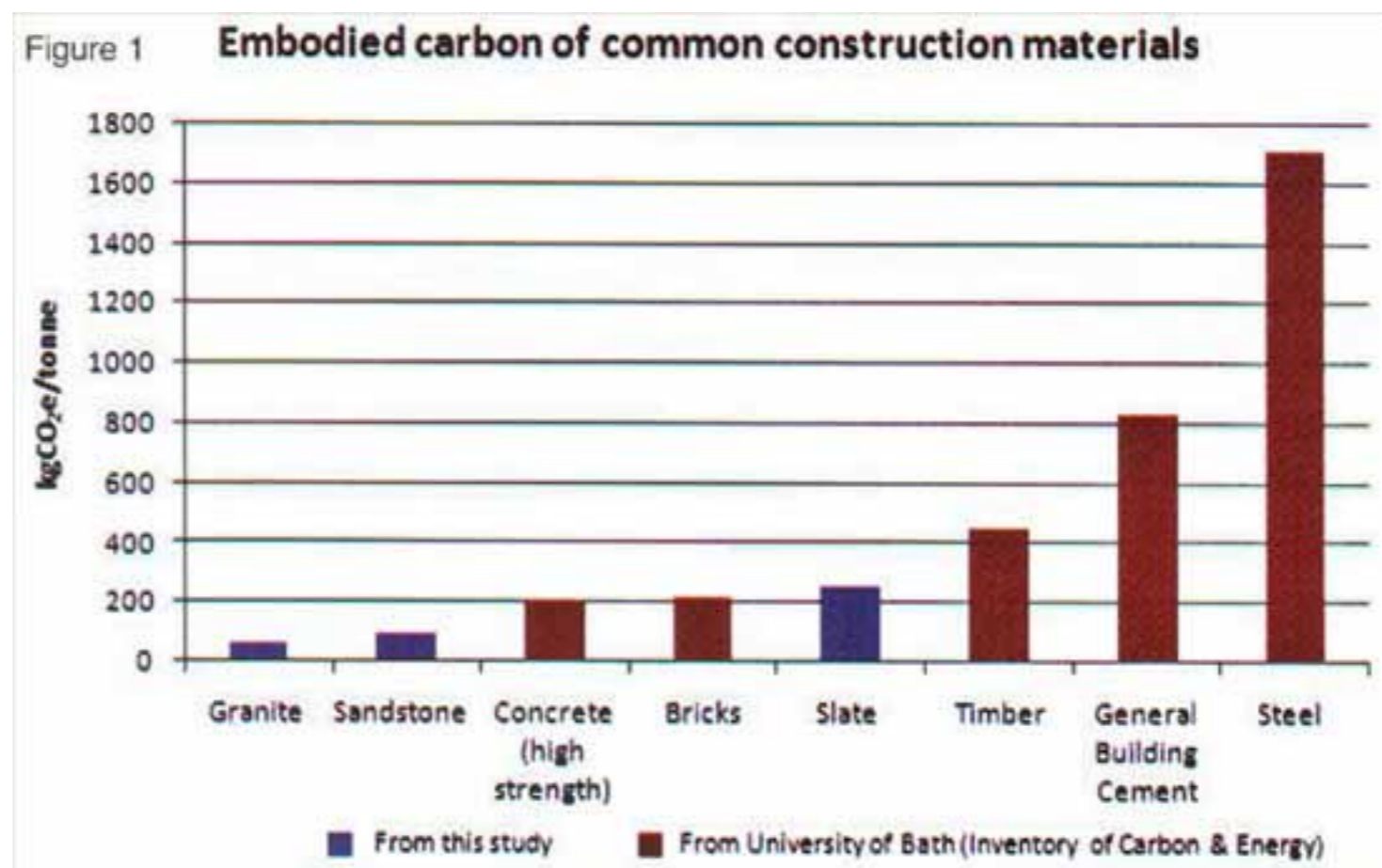

### Kirk ThermalWall

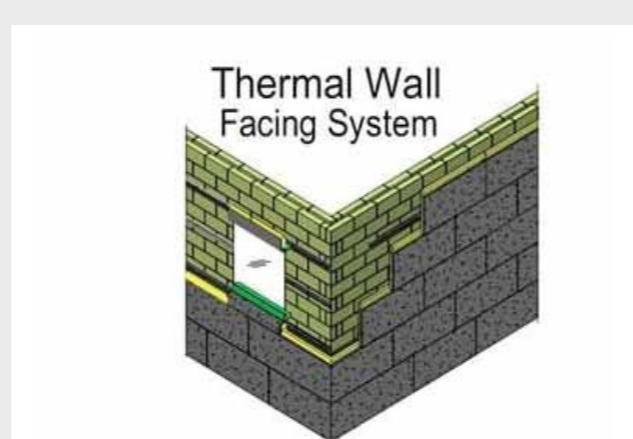

### Commercial Projects



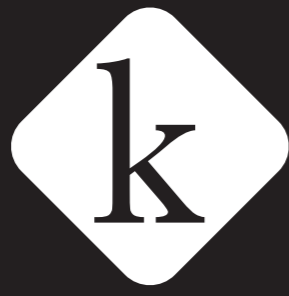

**kirk**  
natural stone  
developments

Contact Us

Tel: 01888 511399

Mob: 07855 986217

Email: info@kirknaturalstone.com

HOME

ABOUT

SERVICES

REQUEST A QUOTE

CONTACT



## Request a Quote

About

Kirk Thermal Wall

Commercial Projects

Sustainability

> Request a Quote

Contact us

### Request a Quote for Your Natural Stone Project

Please use this form to request an outline quote for your commercial or domestic project.

Name

Email

Phone

How would you describe yourself?

Architect

Please outline your requirements:

How did you find us?

Please select...

Send

#### Kirk ThermalWall



#### Commercial Projects





## Contact

About

Kirk Thermal Wall

Commercial Projects

Sustainability

Request a Quote

> Contact us

### Request a Quote

#### Fyvie Workshop (Aberdeenshire)

Kirk Natural Stone Developments Ltd

Bridgend

Fyvie

Turriff

AB53 8LL

All appointments and viewing of stone materials take place at our Fyvie Workshop.

#### Aberdeenshire Office

Tel: 01888 511399

Mob: 07855 986217

Fax: 01888 511525

Email: info@kirknaturalstone.com

Please contact the Aberdeenshire office with all natural stone enquiries.

Google Map

### Kirk ThermalWall



### Commercial Projects

